



Scan to go to website

EXT3-H-T / EXT3-H-R Quick Start Guide

This guide helps you install and use your **EXT3-H-T / EXT3-H-R** for the first time.

Go to <http://www.kramerav.com/downloads/EXT3-H-T> / <http://www.kramerav.com/downloads/EXT3-H-R> to download the latest user manual and check if firmware upgrades are available.

Step 1: Check what's in the box

- ✓ **EXT3-H-T Transmitter / EXT3-H-R Receiver**
- ✓ **1 Bracket set**
- ✓ **4 Rubber feet**
- ✓ **1 Power adapter and cord**
- ✓ **1 Quick start guide**

Step 2: Get to know your EXT3-H-T

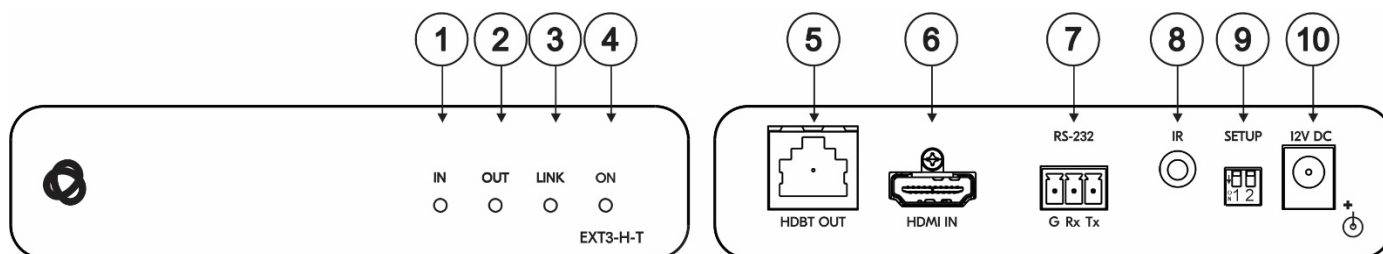

#	Feature	Function
1	IN LED	Lights blue when an active source device input signal is detected.
2	OUT LED	Lights blue when an active, far-end sink (acceptor) connection is detected via the HDBT link.
3	LINK LED	Lights green when an HDBT link is established with the HDBaseT receiver.
4	ON LED	Lights green when the device receives power.
5	HDBT OUT RJ-45 Connector	Connect to a receiver (for example, EXT3-H-R).
6	HDMI IN Connector	Connect to an HDMI source.
7	RS-232 (G, Rx, Tx) 3-pin Terminal Block Connector	This port has two functions selectable by the SETUP DIP-switches: 1. To send/receive RS-232 data over the HDBaseT link. 2. For FW Upgrade.
8	IR 3.5mm Mini Jack Connector	Connect to an external infrared emitter / sensor. The IR signal is passed over the HDBaseT link.
9	SETUP DIP-switches	Set the operation DIP-switches. Refer to Dip Switch Settings on page 3.
10	12V DC Power Connector	12V DC connector for powering the unit.

Step 3: Get to know your EXT3-H-R

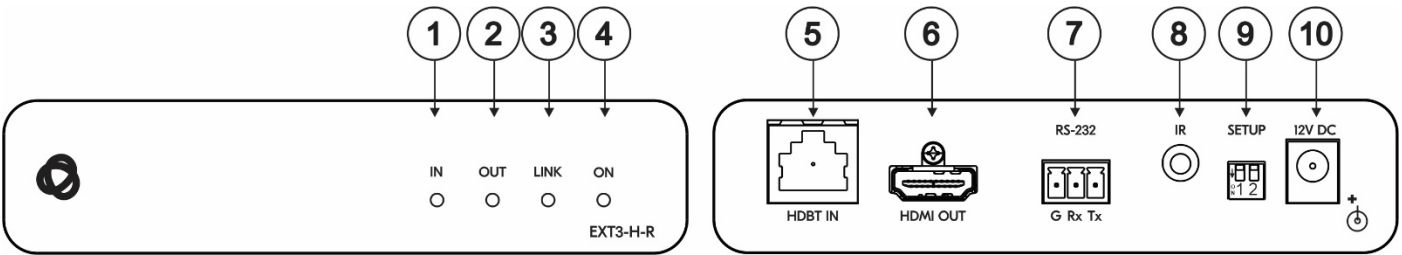

#	Feature	Function
1	IN LED	Lights blue when an active, far-end source device input signal is detected via the HDBT link.
2	OUT LED	Lights blue when an active sink (acceptor) connection is detected.
3	LINK LED	Lights green when an HDBT link is established with the HDBaseT transmitter.
4	ON LED	Lights green when the device receives power.
5	HDBT IN RJ-45 Connector	Connect to a transmitter (for example, EXT3-H-T).
6	HDMI OUT Connector	Connect to an HDMI acceptor.
7	RS-232 (G, Rx, Tx) 3-pin Terminal Block Connector	This port has two functions selectable by the SETUP DIP-switches: 1. To send/receive RS-232 data over the HDBaseT link. 2. For FW Upgrade.
8	IR 3.5mm Mini Jack Connector	Connect to an external infrared emitter / sensor. The IR signal is passed over the HDBaseT link.
9	SETUP DIP-switches	Set the operation DIP-switches. Refer to Dip Switch Settings on page 3.
10	12V DC Power Connector	12V DC connector for powering the unit.

Step 4: Mount EXT3-H-T / EXT3-H-R

Install **EXT3-H-T / EXT3-H-R** using one of the following methods:

- Attach the rubber feet and place the unit on a flat surface.
- Fasten a bracket (included) on each side of the unit and attach it to a flat surface (see www.kramerav.com/downloads/EXT3-H-T / www.kramerav.com/downloads/EXT3-H-R).
- Mount the unit in a rack using the recommended rack adapter (see www.kramerav.com/product/EXT3-H-T / www.kramerav.com/downloads/EXT3-H-R).

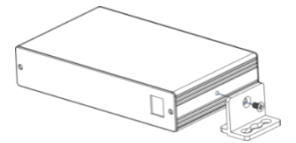

- Ensure that the environment (e.g., maximum ambient temperature & air flow) is compatible for the device.
- Avoid uneven mechanical loading.
- Appropriate consideration of equipment nameplate ratings should be used for avoiding overloading of the circuits.
- Reliable earthing of rack-mounted equipment should be maintained.
- Maximum mounting height for the device is 2 meters.

Step 5: Connect inputs and outputs

Always switch OFF the power on each device before connecting it to your EXT3-H-T / EXT3-H-R. For best results, we recommend that you always use the Kramer high-performance cables to connect AV equipment to EXT3-H-T / EXT3-H-R.



The range between Tx & Rx is:

- 40M – 4K@60
- 70M – 4K@30

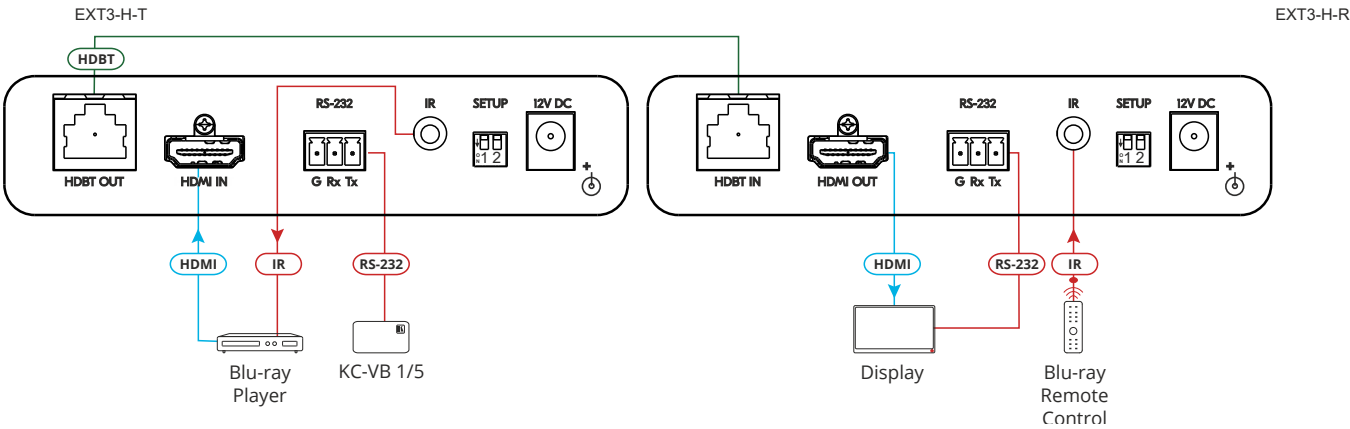

Wiring the RJ-45 Connectors

This section defines the TP pinout, using a straight pin-to-pin cable with RJ-45 connectors.



It is recommended that the cable ground shielding be connected/soldered to the connector shield.

EIA / TIA 568B	
PIN	Wire Color
1	Orange / White
2	Orange
3	Green / White
4	Blue
5	Blue / White
6	Green
7	Brown / White
8	Brown

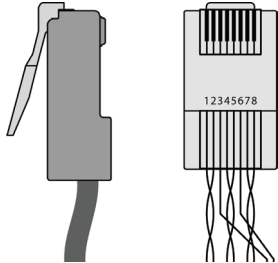

To achieve specified extension distances, use the recommended Kramer cables available at www.kramerav.com/product/EXT3-H-R / [http:// www.kramerav.com/product/EXT3-H-T](http://www.kramerav.com/product/EXT3-H-T). Using third-party cables may cause damage!

Step 6: Dip Switch Settings

The DIP-Switches are used to:

- Configure the IR handling.
- Enable RS-232 signal extension



All the DIP switches are set to OFF (Up) by default.

#	Feature	DIP-switch Settings
1	IR	Off (up) – IR pass-through ON (down) – Add 38kHz modulation
2	RS-232	Off (up) – RS-232 pass-through ON (down) – Valens programming

Step 7: Connect power

Connect the 12V DC power adapters to EXT3-H-T and EXT3-H-R and plug in into the mains electricity.



Safety Instructions (See www.kramerav.com for updated safety information)

Caution:

- There are no operator serviceable parts inside the unit.

Warning:

- Use only the power cord that is supplied with the unit.
- Disconnect the power and unplug the unit from the wall before installing.