



Scan to go to website

PN-6P Quick Start Guide

This guide helps you install and use your **PN-6P** for the first time.

Go to <http://www.kramerav.com/downloads/PN-6P> to download the latest user manual and check if firmware upgrades are available.

Step 1: Check what's in the box

- ✓ 1 **PN-6P** 6.5" two-way Passive Pendant Speaker
- ✓ 1 4-pin pluggable Euroblock connector, 28-12AWG
- ✓ 1 suspension cable kit
- ✓ 1 Quick start guide

Step 2: Get to know your PN-6P

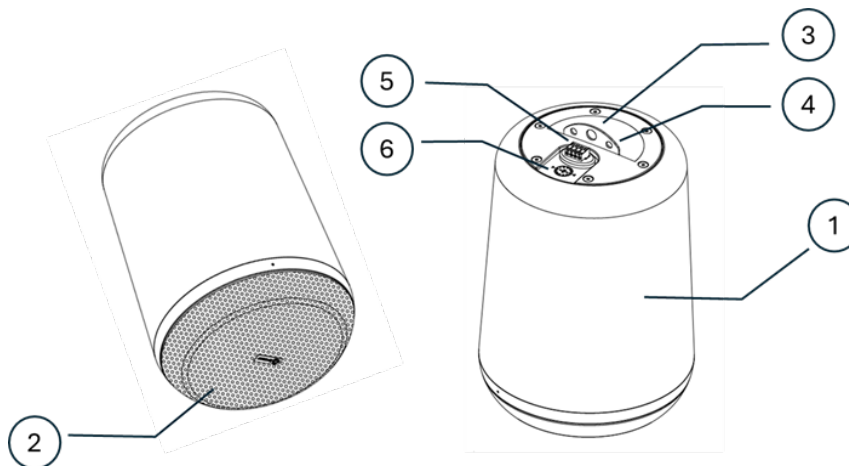

#	Feature	Function
1	Speaker	Speakers body
2	Speaker grill	Speaker's grill
3	Mounting bracket	Connecting the suspension cable
4	Safety anchor point	Secondary safety anchor points for securing a seismic restraint cable
5	Terminal connector	4-pin pluggable Euroblock connector, 28-12AWG for connecting the speaker cables
6	Transformer tap selector	For selecting between 8Ω low-impedance modes and 70V/100V high-impedance modes

Step 3: Key Features

- Premium sound with high SPL
- Low-impedance (8Ω) / high-impedance (70V/100V)
- Power ratings: 30 W (rms) continuous / 45 W (rms) peak
- Sensitivity (1W@1m, free field): 90dB SPL
- Maximum SPL (@1m): Continuous: 105dB SPL / Peak: 107dB SPL
- UL1480A certified for indoor installations
- Industrial design: Available in black & white colors, removable logo
- Eco-friendly mono-material packaging

Step 4: Achieving the Best Performance

To achieve the best performance:

- Use only good quality speaker cables (we recommend Kramer high-performance, BC-2S cables and for plenum installations we recommend the low smoke halogen free cables, BC-2Sxx/LSHF).
- Do not secure the cables in tight bundles or roll the slack into tight coils
- Avoid interference from neighboring electrical appliances that may adversely influence signal quality

Step 5: Choosing the Best Location

- Plan the location of the speakers based on the designated listening area, the height of the ceiling and dispersion angle of the speakers.
- Ceiling Type Suitability: Ensure the ceiling is appropriate for mounting the speaker weight.
- Obstruction Check: Verify the mounting location is free of obstructions like electrical piping, AC ducts, or water lines.
- Ceiling Clearance: Avoid placing speakers too close to the ceiling to prevent sound distortion.
- Avoid Reflective Surfaces: Minimize placement near glass, tiles, or other reflective materials to reduce unwanted echo or reverb.

Step 6: Unpacking

1. Carefully remove the speaker and mounting accessories from the packaging.
2. Inspect all components for damage before proceeding.
3. Dispose of the packaging materials according to regulations.

Step 7: Mounting the Speaker

Terminal Connector
Transformer tap

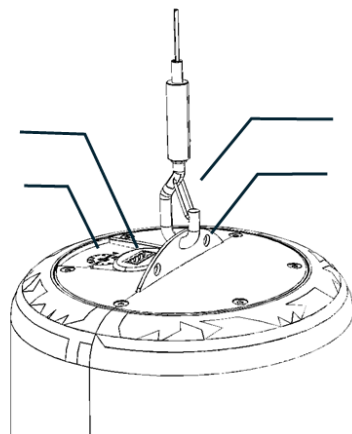

Suspension Cable
Secondary safety
anchor points

- **Step 1: Prepare Mounting Point**
Choose a secure mounting location on the ceiling. Install a suitable ceiling hook, eye bolt, or other mounting hardware (not included) rated to support at least 5x the speaker's weight.
- **Step 2: Attach Suspension Cables**
Use the included suspension cable kit to attach the speaker to the ceiling mount. Make sure the cables are firmly secured and evenly balanced.
- **Step 3: Adjust Height and Level**
Adjust the length of the suspension cables as needed to position the speaker at the desired height and ensure it hangs level.
- **Step 4: Connect Speaker Wires**
Route the speaker cable through the suspension system or conduit. Connect the speaker wires to the terminal block, following the polarity markings and desired 70V/100V/8Ω tap settings.
- **Step 5: Test the System**
Power on the audio system and test the speaker for proper operation and coverage.

Step 8: Wiring the Speaker

Your passive speaker features both low impedance (8Ω) and high impedance (70V/100V) modes. Understanding the difference is essential for safe installation and optimal performance.

- Plan the installation setup (low impedance or high impedance), in case of high impedance determine the rated power of the speaker.

Setting up speaker power handling mode:

Your speaker includes a rotary transformer tap for setting the power handling mode.

- To set the speaker to 8Ω low impedance set the transformer tap so the 2 arrows will point at the 8Ω markings as shown in the picture:

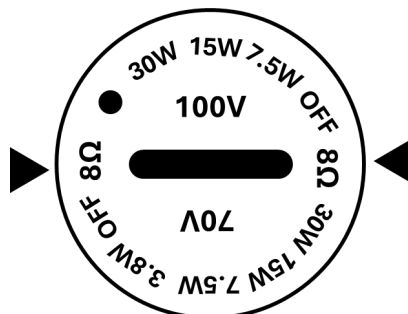

- To set the speaker to a high impedance mode set the transformer tap to the desired power rating as shown in the picture. In this example, if the speaker will be connected to a 100V line its power rating will be 30W and if connected to a 70V line its power rating will be 15W.

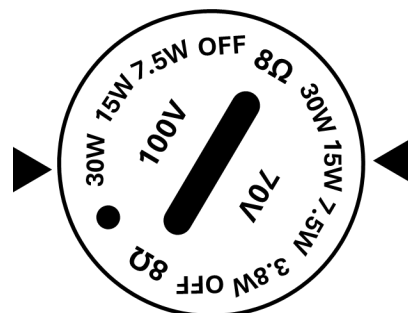

- Connect the speaker cables to the terminal block and the terminal block to the speaker.



Always power off the amplifier before changing transformer tap settings or connecting the terminal connector to the speaker.



Always check amplifier compatibility before connecting (impedance setup, power ratings).



Verify that the polarity of the wiring at the amplifier side and at all the speaker is correct, we recommend using color coding: red for + and black for -.

Parallel Wiring and Daisy Chain Installations

Parallel Wiring

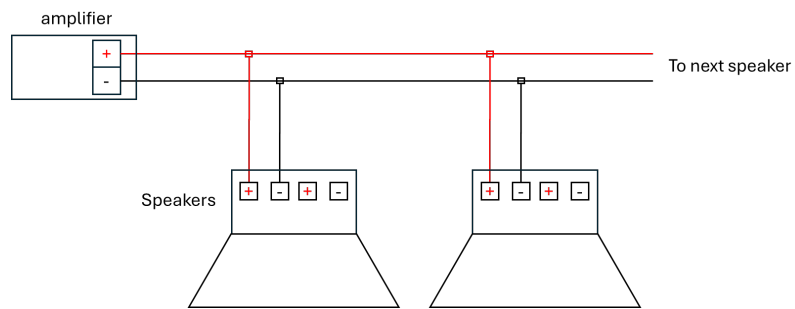

Parallel Wiring - Separate Cables

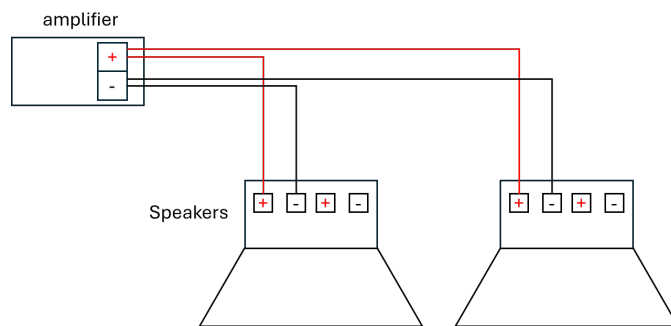

Daisy Chain Wiring

