



# User Manual

OLC III TX/RX

DVI over Fiber Extender Series



## Table of Contents

<b>Introduction</b>	<b>2</b>
<b>Features</b>	<b>2</b>
<b>Application Diagram</b>	<b>3</b>
<b>Panel View</b>	<b>3</b>
OLC III TX/RX	3
LED Indication	4
<b>Functional Description</b>	<b>5</b>
DVI Interface	5
Resolution Capability	5
Fiber Optic Interface	5
Fiber Connector Type	6
EDID Settings	7
Copying Monitor EDID to the DVI Source	7
Factory Default	8
Important EDID Notes	9
<b>Technical Specification</b>	<b>10</b>
<b>Caution</b>	<b>11</b>
<b>Package Includes</b>	<b>12</b>
<b>Installation</b>	<b>13</b>
<b>Warranty</b>	<b>14</b>

## Introduction

OLC III TX/RX is a DVI extender that uses one single-mode or multi-mode mode LC cable to transmit uncompressed full HD DVI signals. The extender provides EDID handling and HDCP compliance. The OLC III TX has the ability to copy the display's EDID through the OLC III RX to align it with the source.

## Features

- Resolution up to 1920x1200 60Hz
- Smart EDID management, learns display's EDID and aligns it with the source
- Transmission distance up to 1km over Single-mode fiber
- Transmission distance up to 300m over Multi-mode fiber
- Autodetects single or multimode LC Fiber Connector

## Application Diagram

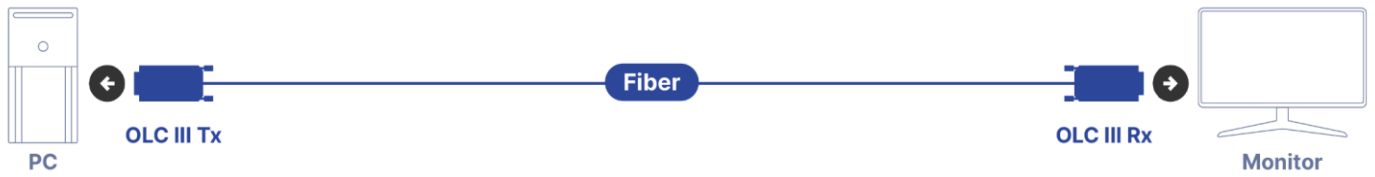

## Panel View

### OLC III TX/RX

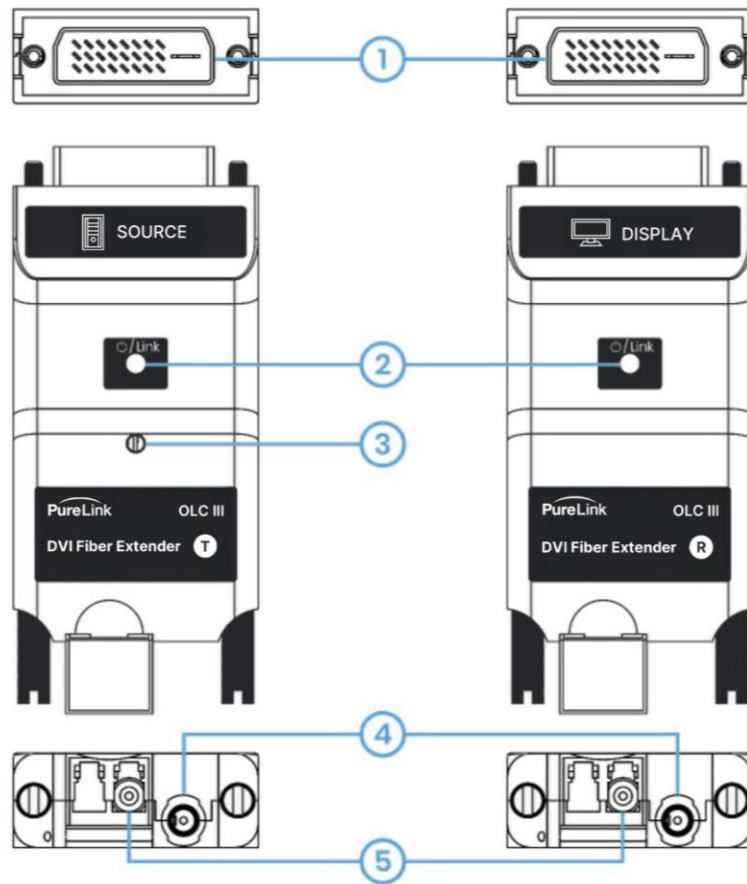

Item	Interface	Description
1	DVI-D connector	25 Pin DVI-D port
2	LED Indicator	Power & Link indicator
3	EDID Copy	EDID Copy Button. Refer to EDID settings
4	DC Jack	5V 1A power
5	LC optical connector	1 LC socket

## LED Indication

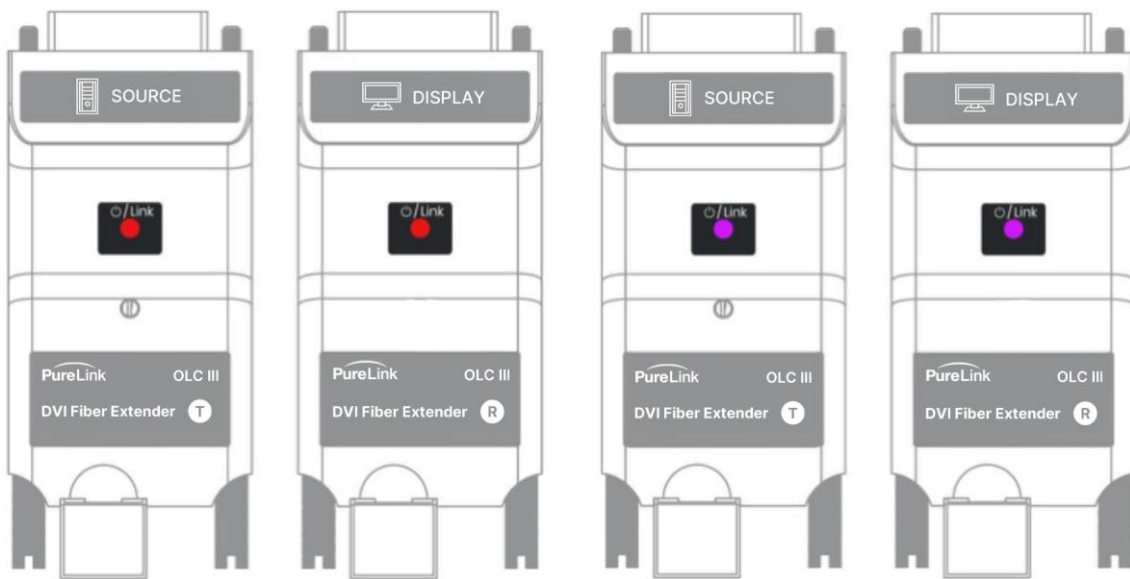

Transmitter/Receiver	LED Status	Description
OLC III TX(Transmitter)/ OLC III RX (Receiver)	Off	No power
	Red	Power On, No or invalid DVI signal
	Purple	Power On, valid DVI signal present

## Functional Description

### DVI Interface

The DVI Video input and output functionality in OLC III TX/RX allows for the transmission and reception of high-definition video signals over optical fiber for longer distances.

### Resolution Capability

OLC III TX/RX handles various resolutions indicated by the table below:

Resolution	
1920x1200	60Hz
1920x1080	50/60/120Hz
1680x1050	60Hz
1600x1200	60/75Hz
1440x900	60Hz
1366x768	60Hz
1360x768	60Hz
1280x1024	60/75Hz
1280x960	60Hz
1280x800	60/75Hz
1280x768	60/75Hz
1280x720	60Hz
1024x768	60/75Hz
800x600	60/75Hz
720x480	60Hz
640x480	60/72/75Hz

### Fiber Optic Interface

OLC III TX/RX is compatible with single-mode and multimode fiber optic cables, offering flexibility in deployment based on distance requirements and installation environments.

OLC III TX converts electrical DVI signals into optical signals by the fiber transmitter module for transmission over fiber optic cables, while OLC III RX converts optical signals back into electrical DVI signals with the fiber receiver module at the receiving end.

### Fiber Connector Type

OLC III TX/RX uses Lucent Connector (LC) type single fiber connectors. The LC connector's small form-factor and single fiber design enable high-density connections and efficient use of fiber optic cables in networking environments.

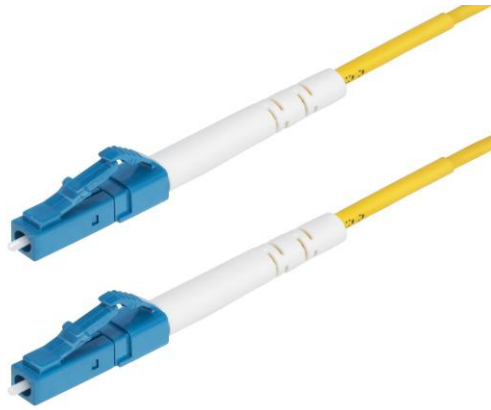

## EDID Settings

### Copying Monitor EDID to the DVI Source

In order to copy the display's EDID, please follow these steps:

1. Fully connect your OLC III extender system to your display and source, and make sure everything is powered on.
2. Press and hold the EDID button on OLC III TX for 3 seconds.
3. After 3 seconds:
  - a. The LED on OLC III TX will start blinking
  - b. The monitor connected to OLC III RX will display a black screen.
4. Release the EDID button.
5. Wait until the OLC III TXs' LED turns to a solid purple. This indicates that the EDID copy is complete and the DVI source is now using the monitor's EDID.



## Factory Default

When powered on and linked for the first time, the OLC III TX provides a default EDID (1080p @ 60Hz) to the DVI source.

To restore the factory default EDID:

1. Press and hold the EDID button on OLC III TX.
2. After 3 seconds, the LED on OLC III TX will start blinking, indicating it has entered EDID copy standby mode.
3. Continue holding the button beyond 3 seconds:
  - a. The LED will turn solid purple after a short moment, indicating that no EDID copy was executed.
  - b. Keep holding the button for 10 seconds.
4. After 10 seconds, the LED will start blinking again, now indicating EDID reset mode.
5. Release the EDID button.
6. Wait until the OLC III TXs' LED turns to a solid purple. This indicates that the EDID reset is complete and the DVI source is now using the default EDID.

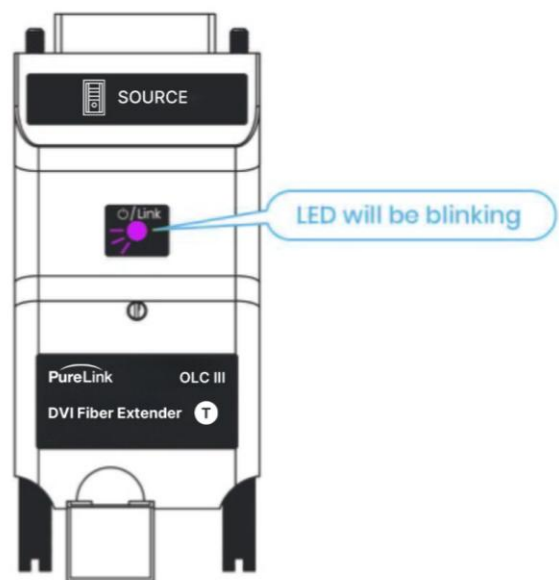
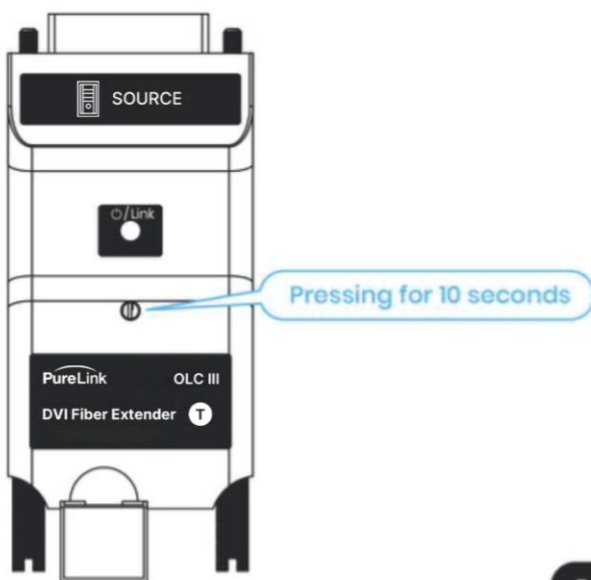

1 2  
3 4

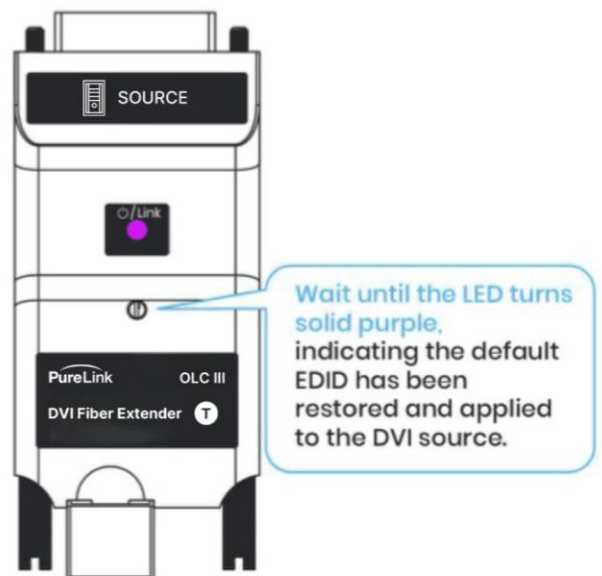
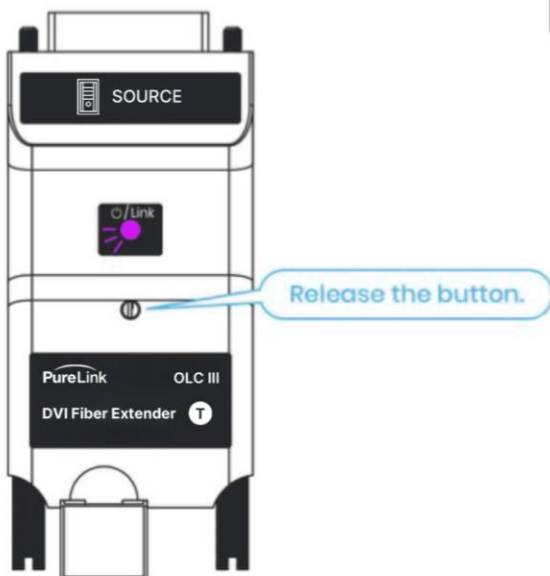

**Important EDID Notes**

- If you change the monitor connected to OLC III RX, you must repeat the EDID copy steps above.
- If this step is skipped, the DVI source will continue to use the previous monitor's EDID.

**Technical Specification**

Item No.	OLC III TX	OLC III RX
Compliance		
Standard	DVI-D HDCP 1.4	
Max. Video Resolution	1920x1200 60Hz	
Max. Transmission Distance	0.62 miles / 1 km over single-mode fiber 1000feet / 304m over muti-mode fiber	
Ports & Interfaces		
Video Input	1 x 25 Pin DVI-D	1 x LC Fiber Connector
Video Output	1 x LC Fiber Connector	1 x 25 Pin DVI-D
Power Input	1 x DC Jack	1 x DC Jack
Power		
Power Supply	5V 1A	5V 1A
Power Consumption	< 2W	< 2W
Ambient Temperature		
Operation	0 to 131°F / 0 to 55°C	
Storage	-40 to 176°F / -40 to 80°C	
Operating Altitude	6562 feet / 2000m	
Humidity	Up to 95%	
Physical Characteristics		
Dimension	3.5 x 1.54 x .60 in / 89 x 39 x 15mm	3.5 x 1.54 x .60 in / 89 x 39 x 15mm
Weight	0.22 lbs / 101.8 g	0.22 lbs / 101.8 g

## Caution

1. This product is designed for indoor applications. If you plan to use it outdoors, it is recommended installing additional equipment for waterproof protection and surge protectors to prevent damage caused by lightning.
2. Do not put anything on the power and system cables, place them where they cannot be stepped on. Please ensure there is nothing resting on any cables.
3. Avoid using this product in proximity of water, or near high temperature devices such as radiators, stoves, etc.
4. Shut down the power supply and unplug all equipment immediately if:
  - A. water or any kind of liquid has spilled into the product
  - B. the product has been damaged by external force
  - C. the product does not operate normally as this manual indicates
  - D. Please contact us for further repair if the above conditions happen.
5. Using standardized and certified optical fiber cables to transfer high-resolution video is recommended.

### Package Includes

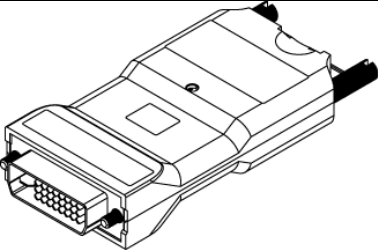
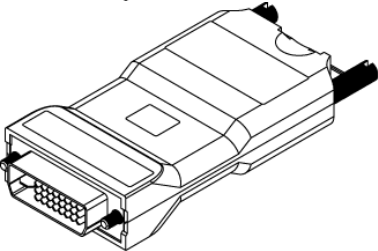
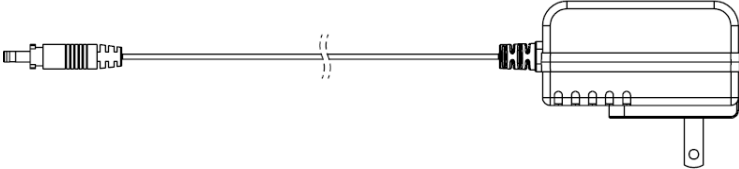
Item	Amount	Image
OLC III TX	1 pc	
OLC III RX	1 pc	
DC 5V2A Power Adapter	2 pcs	

# Installation

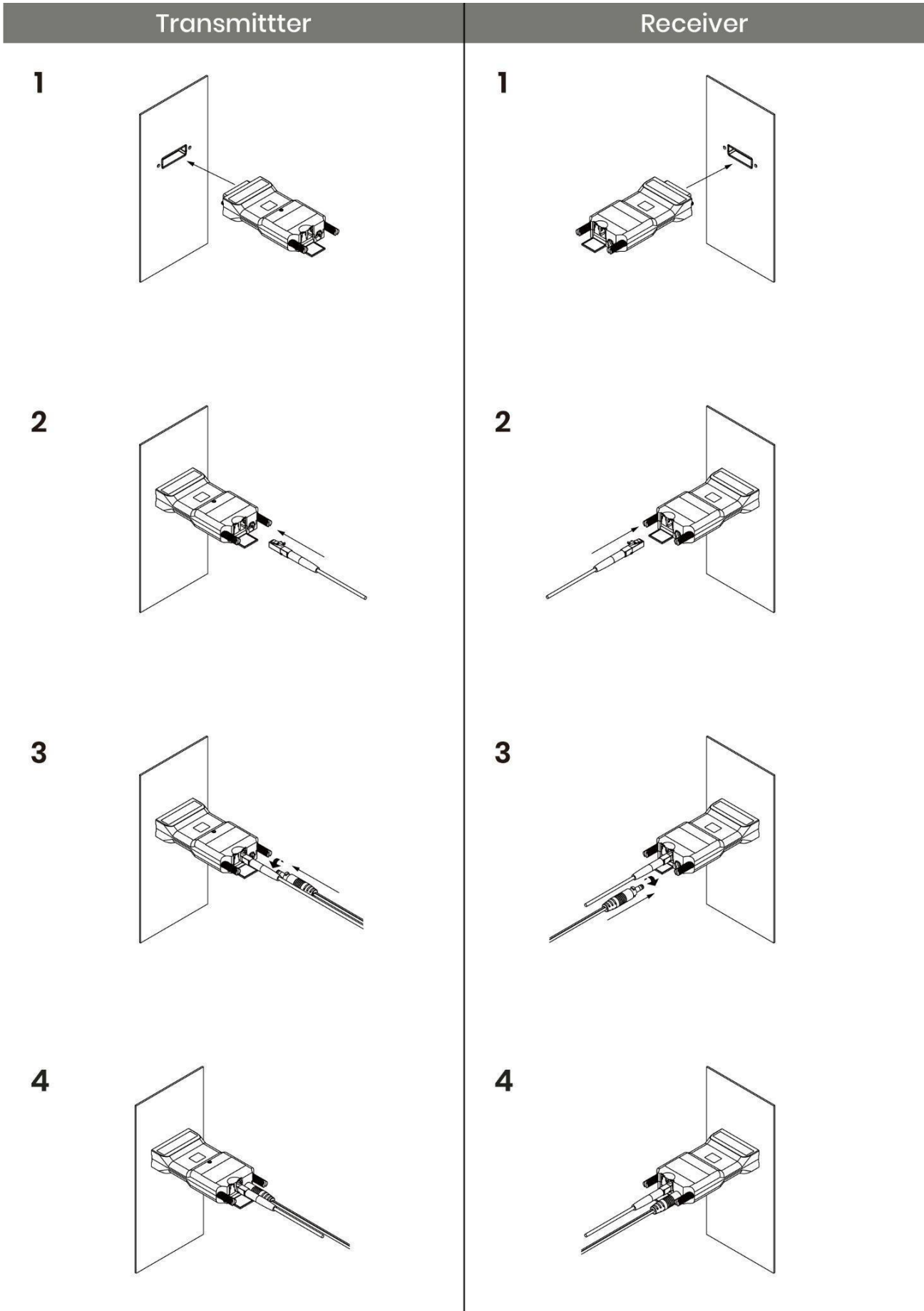

## **Warranty**

PureLink Three (3) Year Limited Warranty for PureStream™ Branded Products Only  
Dtrovision, LLC. (hereinafter "PureLink") warrants its HDTools and PureStream™ branded products (hereinafter "Product") purchased directly from PureLink or Dealer shall be free from defects in workmanship and materials, under normal use and service, for a period of three (3) years on parts and three (3) years on labor. Any repaired or replaced equipment related to Product shall be covered only under the remaining portion of the warranty. This warranty has no relationship to and exists independently of any warranty offered by Dealer. This warranty is a limited warranty and gives you specific legal rights. You may also have other rights which vary from state to state.

## **TERMS & CONDITIONS**

PureLink shall repair or replace the Product if it develops a material fault during the period of warranty, on condition that i) the Product has only been subject to normal use in a domestic or commercial environment in a manner consistent with its specification and functionality, ii) the Product has been cared for reasonably and only subjected to reasonable wear and tear, iii) the defect has not been caused by willful or negligent abuse or neglect, or any accident or improper installation procedure, iv) the serial number of the Product has not been altered or removed. This warranty only applies to the original purchaser, and shall be the exclusive remedy to the original purchaser. PureLink shall not be liable for any damages whatsoever caused by Product or the failure of Product to perform, including incidental or consequential damages. PureLink shall not be liable for any claim made by a third party or made by the purchaser for a third party. Except as expressly set forth in this warranty, PureLink makes no other warranties, expressed or implied, including any implied warranties of merchantability and fitness for a particular purpose. PureLink expressly disclaims all warranties not satisfied in this limited warranty. Any implied warranties that may be imposed by law are limited to the terms of this limited warranty. This warranty statement supersedes all previous warranties.

## **WARRANTY RETURNS/REPAIRS/EXCHANGES**

No merchandise may be returned without prior authorization from PureLink, and a Return Materials Authorization (RMA) number. Failure to comply with these conditions will result in rejection of the returned merchandise. Any warranty service on Products must be arranged through Dealer. Authorized returns must be shipped freight prepaid and fully insured to PureLink, Fair Lawn, NJ USA, with the RMA number clearly marked on the outside of all shipping boxes and containers. PureLink reserves the right at its sole discretion to refuse any shipments arriving freight collect or without an RMA number. Any authorized returned merchandise must be accompanied by a note describing the reason for return, along with contact information including name, phone number, return mailing and shipping addresses, e-mail address, and RMA number. On any products returned and accepted with an RMA number, return freight charges following repair of items under warranty shall be paid by PureLink, shipping by the standard ground carrier of its choice.

## **ADVANCE WARRANTY REPLACEMENTS**

PureLink's advanced replacement service offers a Replacement Unit upon request - free of charge for

eligible products purchased less than one (1) year of the warranty claim. Products purchased more than one (1) year prior to the warranty claim do not qualify for advance replacement services. Advance replacement requests must be validated by a member of PureLink's Technical Support Team.

Replacement units may be new or refurbished and are subject to availability. PureLink is responsible for shipping the Replacement Unit to your designated location by standard ground service. All other shipping methods will be the responsibility of the Dealer. Original Unit Return – the Original Unit must be returned within thirty (30) calendar days of the return authorization date. Failure to return the Original Unit within this period will be subject to a minimum 15% re-stocking fee. Dealer is solely responsible for the shipping of the Original Unit to PureLink.

### **TO MAKE A WARRANTY CLAIM**

To make a warranty claim, promptly notify PureLink within the warranty periods described above by calling PureLink's Technical Support Department at 1-201-488-3232. PureLink, in its sole discretion, will determine what action, if any, is required under this warranty. Most problems can be corrected over the phone through close cooperation between Customer and a PureLink technician. To better enable PureLink to address a warranty claim, please have the Product's serial and model numbers. If PureLink, in its sole discretion, determines that an on-site visit or other remedial action is necessary, PureLink may send a representative to the customer's site.

Technical Support

22-10 State Route 208 Fair Lawn, NJ 07410 USA

Technical support inquiries can be submitted electronically through the PureLink website at [www.purelinkav.com](http://www.purelinkav.com).

For immediate assistance please contact PureLink's Customer Care Team at +1 (201) 488-3232.